



Millmead Way, Hertford, SG14 3YH |  
£349,995 | Freehold

## Millmead Way, Hertford, SG14 3YH

Situated within close proximity to Hertford North Station and the town centre, this chain-free, recently built one-bedroom property offers a convenient and modern living experience. Featuring a private 35ft rear garden, this end of terraced house boasts open plan living, ideal for entertaining guests or simply relaxing in comfort. The property has been recently renovated to a high standard, with new UPVC windows and French doors installed, as well as a combi boiler for efficient heating. The bedroom includes built-in wardrobes for added storage space. Additionally, ample parking is available to front and rear, making it easy for residents to come and go as they please. This property is a must-see for those seeking a contemporary home in a desirable location.

### Key features

- Close proximity to Hertford North Station and town centre
- Modern open plan living space
- Efficient combi boiler for heating
- Ample parking available to front and rear
- Private 35ft rear garden
- Recently renovated with new UPVC windows and French doors
- Built-in wardrobes in bedroom
- Desirable end of terraced location with views of green space

### Property Information

Tenure  
Freehold

Council Tax  
C



 paulwallace  
estate agents

[hoddesdon@paulwallace.co.uk](mailto:hoddesdon@paulwallace.co.uk)

01992 466471





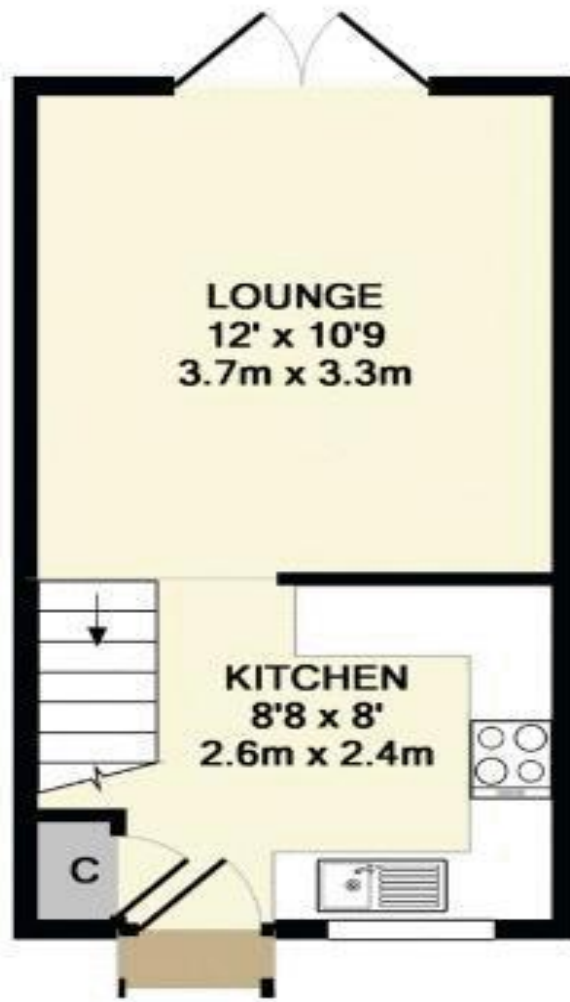

**LOUNGE**  
12' x 10'9"  
3.7m x 3.3m

**KITCHEN**  
8'8" x 8'  
2.6m x 2.4m

C

GROUND FLOOR

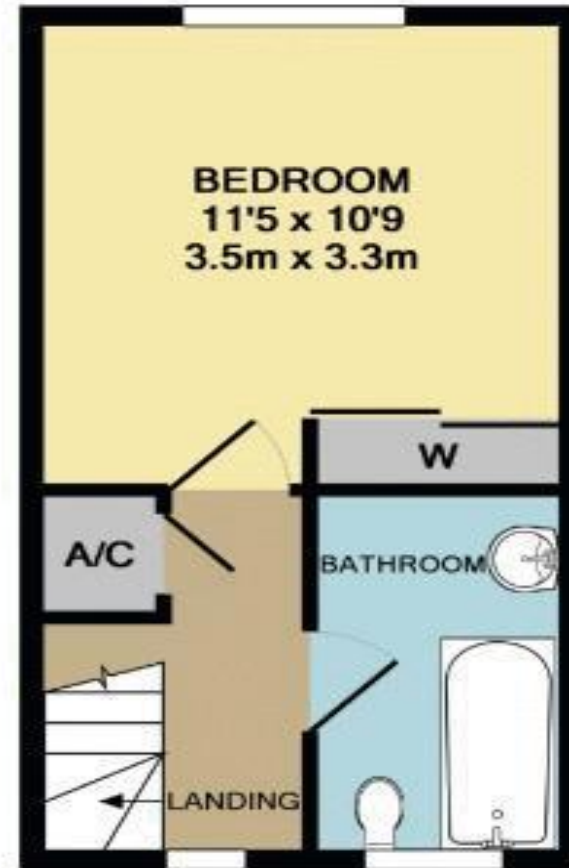

**BEDROOM**  
11'5" x 10'9"  
3.5m x 3.3m

W

A/C

BATHROOM

LANDING

1ST FLOOR

Whilst every attempt has been made to ensure the accuracy of the floor plan contained here, measurements of doors, windows, rooms and any other items are approximate and no responsibility is taken for any error, omission, or mis-statement. This plan is for illustrative purposes only and should be used as such by any prospective purchaser. The services, systems and appliances shown have not been tested and no guarantee as to their operability or efficiency can be given.

Made with Metropix ©2019





Registered Address: Unit 3 The Brookfield Centre, Cheshunt, Herts, EN8 0NN Company Registration Number: OC414280 | VAT Number: 276958046©2022 Paul Wallace Group LLP trading as Paul Wallace Estate Agents



### Paul Wallace Estate Agents

70 High Street  
Hoddesdon  
Hertfordshire  
EN11 8ET

 01992 466471

 [hoddesdon@paulwallace.co.uk](mailto:hoddesdon@paulwallace.co.uk)

 [www.paulwallace.co.uk](http://www.paulwallace.co.uk)



### Opening Times

Mon	9am to 6.30pm
Tues	9am to 6.30pm
Wed	9am to 6.30pm
Thurs	9am to 6.30pm
Fri	9am to 6.30pm
Sat	9am to 5.00pm
Sun	Closed



Agents Note: Whilst every care has been taken to prepare these sales particulars, they are for guidance purposes only. All measurements are approximate and are for general guidance purposes only and whilst every care has been taken to ensure their accuracy, they should not be relied upon. Potential buyers are advised to recheck the measurements.